



Facade SON1-R3

## Lot 74B - Stage 2A

# \$779,000

4

Bedroom

2

Bathroom

2

Garage

202.4

GFA M2

### COMFORT PACKAGE OVERVIEW

- EXSULITE® THERMAL FACADE CLADDING SYSTEM RENDERED FINISH
- TIMBER FRAMES AND TRUSSES
- COLORBOND ROOF, FASCIA AND GUTTER
- MOTORISED GARAGE DOOR
- 7-STAR BASIX PROVISIONS
- HI-WALL REVERSE CYCLE AIR CONDITIONING
- SLIDING WINDOWS AND DOORS
- SQUARE SET PLASTERBOARD FINISH
- INCLUDES COVERED PATIO
- ABDUNDANCE PACKAGE UPGRADE AVAILABLE



Facade SON1-R2



Facade SON1-R1

E. [housetand@yarrahass.com.au](mailto:housetand@yarrahass.com.au)

W. [YarrahYass.com.au](http://YarrahYass.com.au)

# SON1 Sonneteer Series

## Lot 74B-Stage 2A

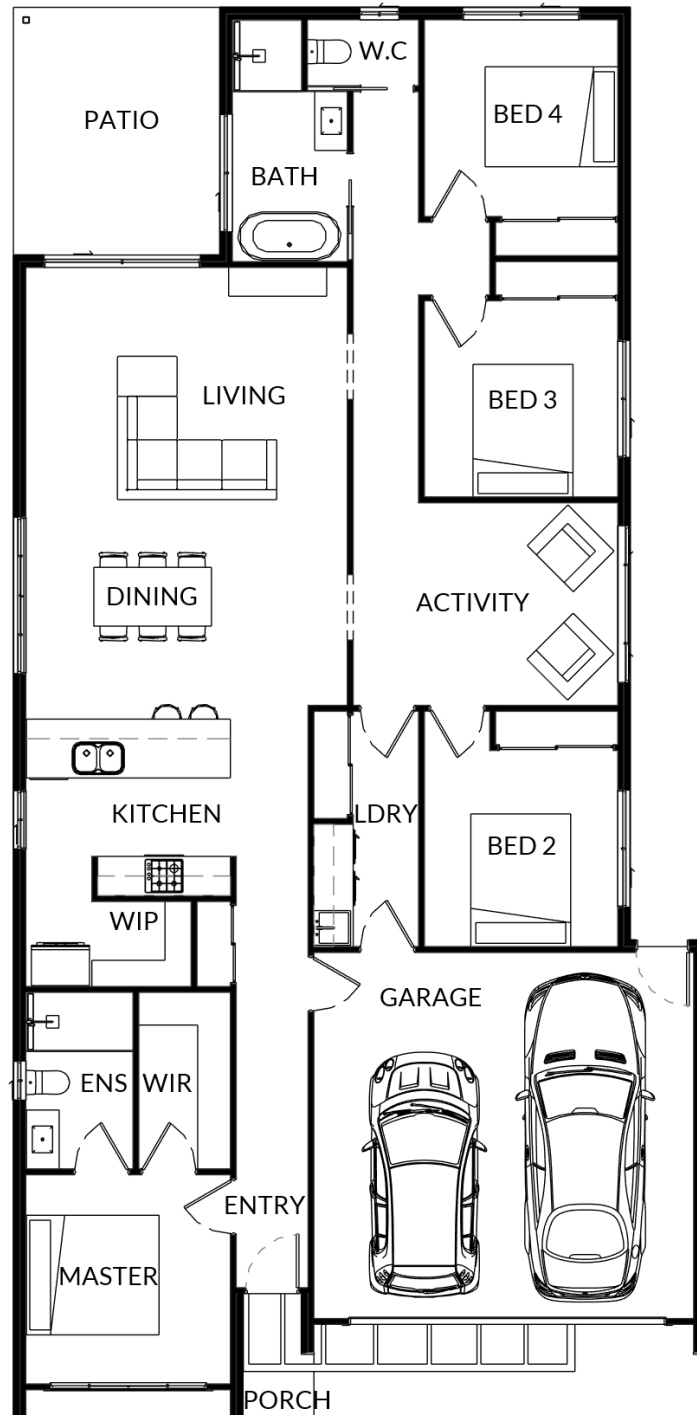

\*Conditions apply to all House and Land Packages: WMD Construction as the licenced builder will provide a construction contract for the house and the purchaser will separately enter into a contract to purchase the land directly from the landowner. This advertised offer is subject to availability, statutory approval and a successful settled land contract. WMD Construction reserves the right to change prices or inclusions advertised without further notice. For additional information on detailed house pricing, including standard house inclusions, house package inclusions, optional upgrades and variations, please talk to one of our consultants. The images shown in this brochure may include upgraded fixtures, finishes and features including some items that subject to the package selected by the purchaser may not be supplied by WMD Construction such as window and household furnishing, landscaping, fencing, paving and footpath. The plan and facade renders are copyright of WMD Construction ABN 98 604 001 783, Licence number 399772C and no part may be reproduced or copied without prior written consent.